

U. S. Army Research Studies
of The Effects of The Premier All Natural Filters Inc.. Clensite™ Filters

Interim Report
Review of Natick Data regarding Premier All Natural Filters, Inc. Fridge Filters
March 6, 2008

Studies Performed by:
Natick Soldier Research, Development and Engineering Center
Performance Enhancement and Food Safety
AMSRD-NSC-CF-P
Natick, MA 01760-5000

This study report was compiled from U. S. Army reports and data submitted to Premier All Natural Filters, Inc. pursuant to an agreement to share research data on the Clensite™ Humidity Control Filters. This copy is an interim report as of the above date, and may be further amplified by subsequent reports. The U. S. Army does not endorse these products

<<Premier All Natural Filters Inc. Mold Study.xls>>

Adrian,

Attached is the baseline information and pictures from our existing effort as promised.

Paul W Maguire
Food Technologist
Natick Soldier Center
CFD: PEFST
Tel: 508 234-5686
Fax 508 234-5181

Premier All Natural Filters
Mold Study:

40F Box was emptied of contents and cleaned to determine baseline mold spores in box headspace

Food components were replaced and allowed to equilibrate for 2hours
Then PDA and Nutrient Agar plates were placed at specific locations for 30 minutes exposure time

Baseline Mold and Bacterial Spore Results:

Placement in box:	PDA Plates:	Nutrient Agar:
FLH:	<1	9 (4 mold)
FLL:	<1	1
FRH:	1	1
FRL:	<1	7 (1 mold)
MLH:	1	4 (1 mold)
MLL:	1	3 (1 mold)
MRH:	1	5 (2 mold)
MRL:	<1	2
BLH:	<1	1
BLL:	<1	4 (1 mold)
BRH:	6	1
BRL:	1	<1
BBH:	<1	1
BBL:	<1	1
Totals:	11 mold colonies	40 bacterial/mold colonies

Baseline Test Results (Before Installation of Clensite™ Humidity Control Filters)

Walk-in 40°F Refrigerator Tests

PDA and Nutrient Agar Plates were placed at (below) specific Locations in the Box:
 ~ 30 minutes Exposure Time in box

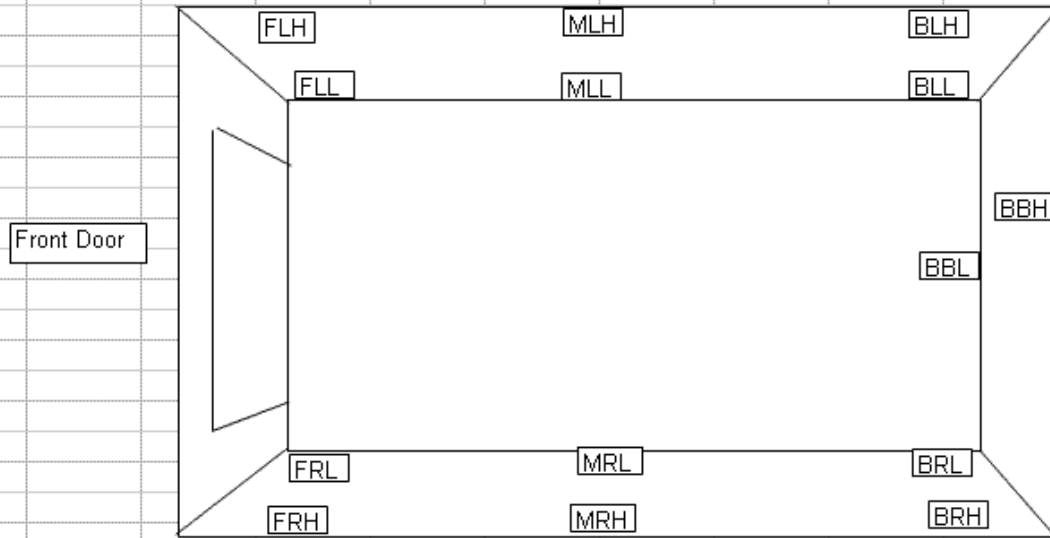

Mold and Bacteria Test Set-up

KEY:		
FLH:	Front Left High	
FLL:	Front Left Low	
FRH:	Front Right High	
FRL:	Front Right Low	
MLH:	Middle Left High	
MLL:	Middle Left Low	
MRH:	Middle Right High	
MRL:	Middle Right Low	
BLH:	Back Left High	
BLL:	Back Left Low	
BRH:	Back Right High	
BRL:	Back Right Low	
BBH:	Back Back High	
BBL:	Back Back Low	

5 week Assessment of Premier All Natural Filters: Mold and Bacterial Spore Results:

Placement in box:	PDA Plates:	Nutrient Agar:
FLH:	<1	<1
FLL:	<1	<1
FRH:	<1	<1
FRL:	<1	<1
MLH:	<1	1
MLL:	<1	1
MRH:	<1	1
MRL:	<1	1
BLH:	<1	<1
BIL:	<1	<1
BRH:	<1	1
BRL:	<1	<1
BBH:	<1	1
BBL:	<1	1
Totals:	<1	7 bacteria colonies

<<Premier All Natural Filters Mold Study (2).xls>>

The filters are definitely working.

Will get you a more formal write up, when I have time to put it on paper.

Paul W Maguire
Food Technologist
Natick Soldier Center
CFD: PEFST
Tel: 508 234-5686
Fax 508 234-5181

(See Results Below)

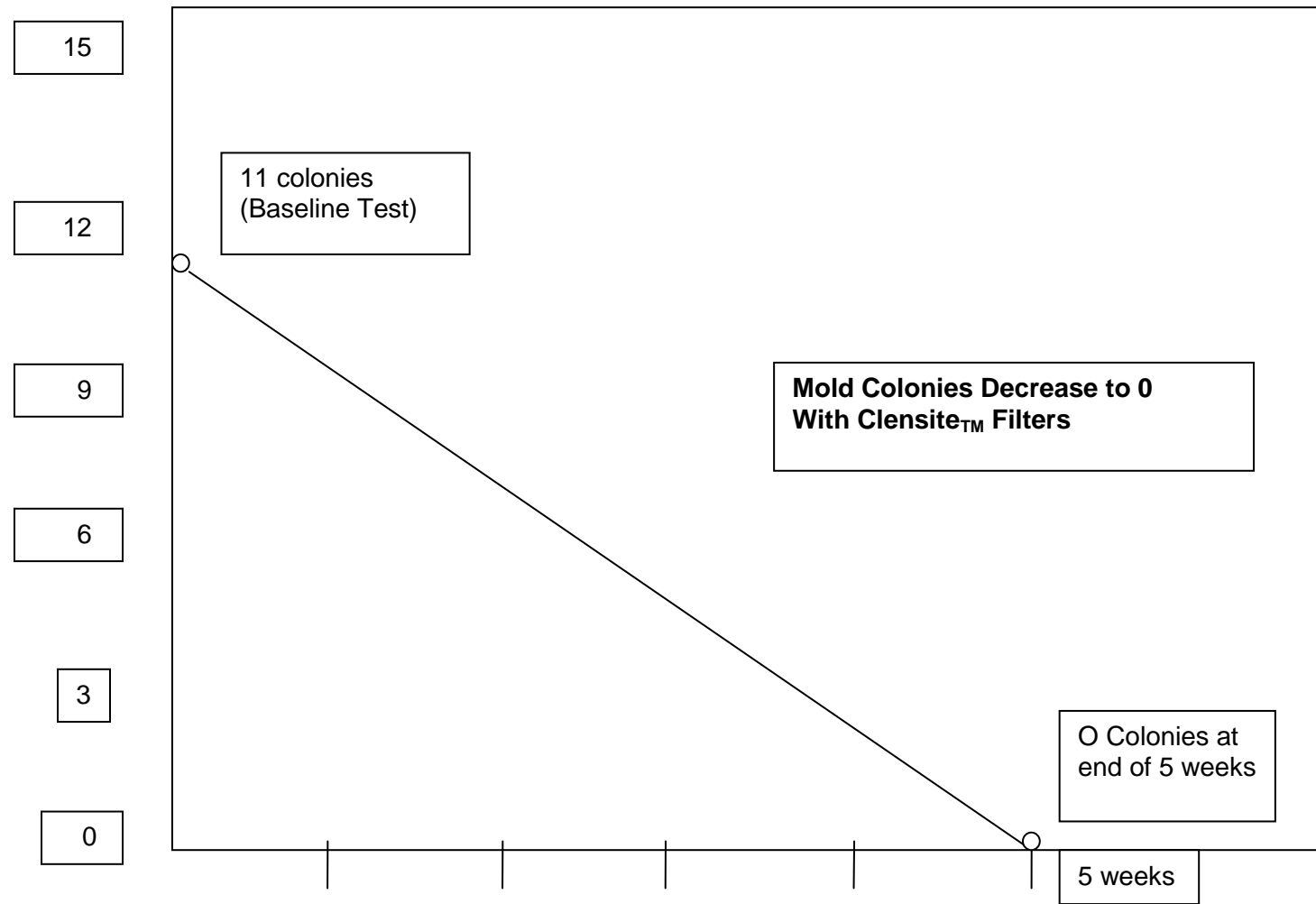

Clensite™ Filter Mold Test

